

# Illustrated Index

## Rear Cover

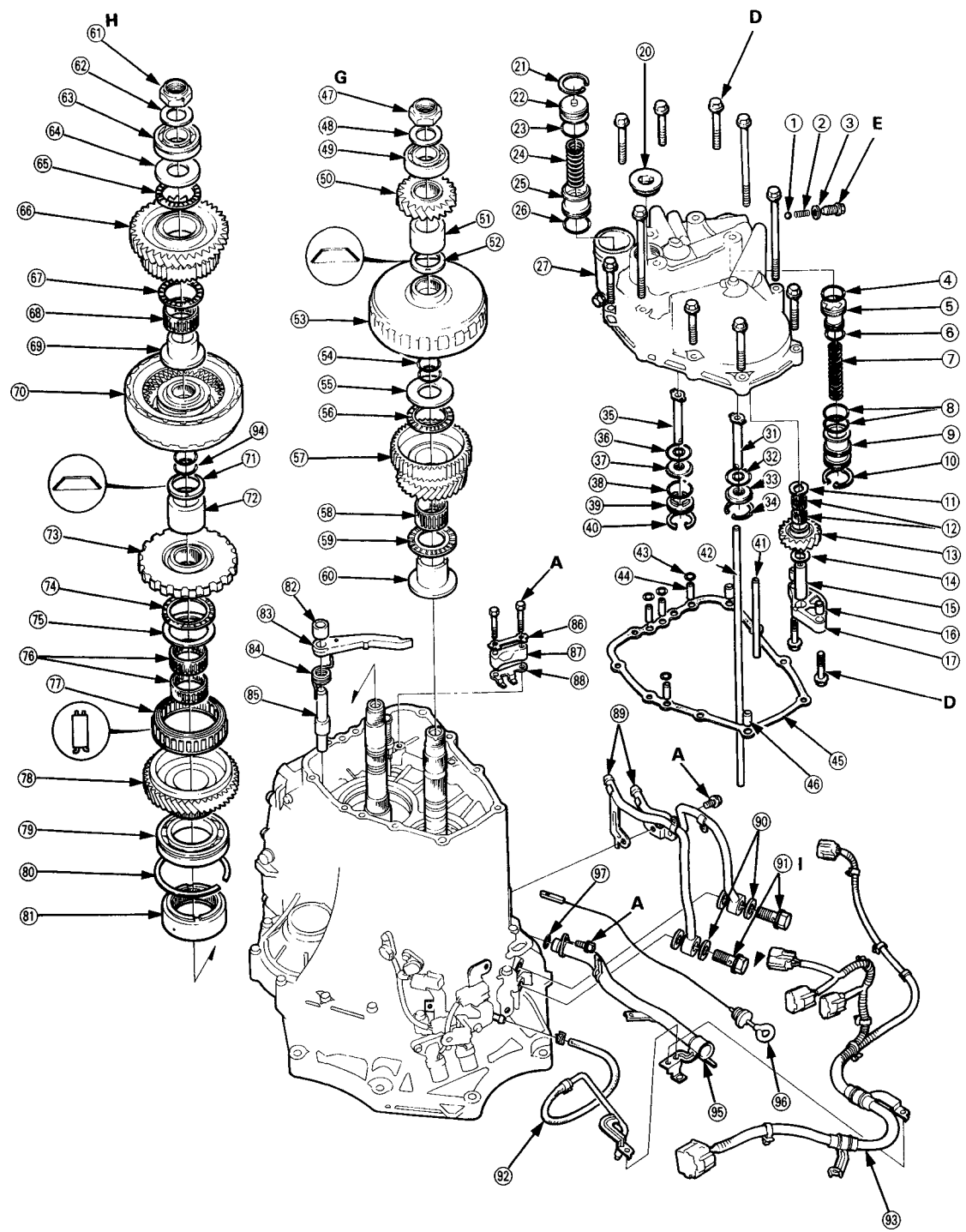



- ① STEEL BALL
- ② ONE-WAY BALL SPRING
- ③ SEALING WASHER Replace.
- ④ O-RING Replace.
- ⑤ REVERSE ACCUMULATOR PISTON
- ⑥ O-RING Replace.
- ⑦ REVERSE ACCUMULATOR SPRING
- ⑧ O-RINGS Replace.
- ⑨ REVERSE ACCUMULATOR SLEEVE
- ⑩ SNAP RING
- ⑪ THRUST WASHER, 14 x 30 mm
- ⑫ NEEDLE BEARINGS
- ⑬ REVERSE IDLER GEAR
- ⑭ THRUST WASHER, 14 x 25 mm
- ⑮ REVERSE IDLER GEAR SHAFT
- ⑯ DOWEL PIN
- ⑰ REVERSE IDLER GEAR SHAFT HOLDER
- ⑲ SEALING BOLT 34 x 1.25 mm
- ⑳ SNAP RING
- ㉑ 1ST-HOLD ACCUMULATOR SLEEVE
- ㉒ O-RING Replace.
- ㉓ 1ST-HOLD ACCUMULATOR SPRING
- ㉔ 1ST-HOLD ACCUMULATOR PISTON
- ㉕ O-RING Replace.
- ㉖ REAR COVER
- ㉗ 2ND CLUTCH FEED PIPE
- ㉘ O-RING Replace.
- ㉙ FEED PIPE GUIDE
- ㉚ SNAP RING
- ㉛ REVERSE CLUTCH FEED PIPE
- ㉜ O-RING Replace.
- ㉝ FEED PIPE GUIDE
- ㉞ O-RING Replace.
- ㉟ OIL FEED GUIDE
- ㊱ SNAP RING
- ㊲ FEED PIPE
- ㊳ FEED PIPE
- ㊴ O-RING Replace.
- ㊵ OIL PIPE
- ㊶ REAR COVER GASKET Replace.
- ㊷ DOWEL PIN
- ㊸ MAINSHAFT LOCKNUT, 24 x 1.25 mm  
Replace.
- ㊹ WASHER, 24 mm  
Replace.
- ㊺ BALL BEARING
- ㊻ MAINSHAFT REVERSE GEAR
- ㊼ MAINSHAFT REVERSE GEAR DISTANCE COLLAR
- ㊽ MAINSHAFT DISC SPRING, 28 mm  
Replace.
- ㊾ 2ND CLUTCH ASSEMBLY
- ㊿ O-RING Replace.
- ⑤① THRUST WASHER, 29 mm
- ⑤② THRUST NEEDLE BEARING
- ⑤③ MAINSHAFT 2ND GEAR
- ⑤④ NEEDLE BEARING
- ⑤⑤ THRUST NEEDLE BEARING
- ⑤⑥ MAINSHAFT 2ND GEAR COLLAR
- ⑤⑦ COUNTERSHAFT LOCKNUT, 24 x 1.25 mm  
Replace.
- ⑤⑧ WASHER, 24 mm Replace.
- ⑤⑨ BALL BEARING
- ⑤⑩ THRUST WASHER, 25 mm
- ⑤⑪ THRUST NEEDLE BEARING
- ⑤⑫ COUNTERSHAFT REVERSE GEAR
- ⑤⑬ THRUST NEEDLE BEARING
- ⑤⑭ NEEDLE BEARING
- ⑤⑮ COUNTERSHAFT REVERSE GEAR COLLAR
- ⑤⑯ REVERSE CLUTCH ASSEMBLY
- ⑤⑰ COUNTERSHAFT DISC SPRING, 29 mm  
Replace.
- ⑤⑱ REVERSE CLUTCH DISTANCE COLLAR
- ⑤⑲ PARKING GEAR
- ⑤⑳ THRUST NEEDLE BEARING
- ⑤㉑ THRUST WASHER, 45.5 x 60 mm Selective part
- ⑤㉒ NEEDLE BEARINGS
- ⑤㉓ 2ND GEAR ONE-WAY CLUTCH
- ⑤㉔ COUNTERSHAFT 2ND GEAR
- ⑤㉕ BALL BEARING
- ⑤㉖ SNAP RING
- ⑤㉗ ONE-WAY CLUTCH HUB
- ⑤㉘ PARKING BRAKE PAWL SHAFT SLEEVE
- ⑤㉙ PARKING BRAKE PAWL
- ⑤㉚ PARKING BRAKE PAWL SPRING
- ⑤㉛ PARKING BRAKE PAWL SHAFT
- ⑤㉜ LOCK PLATE Replace.
- ⑤㉝ PARKING BRAKE ROD HOLDER
- ⑤㉞ PARKING BRAKE ROD GUIDE
- ⑤㉟ ATF COOLER PIPES
- ⑥① SEALING WASHERS Replace.
- ⑥② JOINT BOLTS
- ⑥③ BREATHER PIPE
- ⑥④ TRANSMISSION SUB-HARNESS
- ⑥⑤ O-RING Replace.
- ⑥⑥ ATF LEVEL GAUGE PIPE
- ⑥⑦ ATF LEVEL GAUGE (DIPSTICK)
- ⑥⑧ O-RING Replace.

## TORQUE SPECIFICATIONS

No.	Torque Value	Bolt Size	Remarks
A	12 N·m (1.2 kg-m, 9 lb-ft)	6 x 1.0 mm	
D	27 N·m (2.7 kg-m, 20 lb-ft)	8 x 1.25 mm	
E	18 N·m (1.8 kg-m, 13 lb-ft)	8 x 1.25 mm	Sealing Bolt
G	130 N·m (13.0 kg-m, 94 lb-ft)	24 x 1.25 mm	Mainshaft Locknut
H	130 N·m (13.0 kg-m, 94 lb-ft)	24 x 1.25 mm	Countershaft Locknut (Left-hand threads)
I	40 N·m (4.0 kg-m, 29 lb-ft)	14 x 1.5 mm	Joint Bolt